

NOTE: BREAK ALL CORNERS WITH 0.015" (.38 MM) RADIUS UNLESS OTHERWISE NOTED. STANDARD TOLERANCES TO APPLY UNLESS OTHERWISE SPECIFIED.

CUSTOMER PART No.	CAN ART STD.	DIE No. EH05766
DESCRIPTION	3.000 x 1.500 x 0.188 THK. RECT. TUBE	PROPOSAL No. H-12541

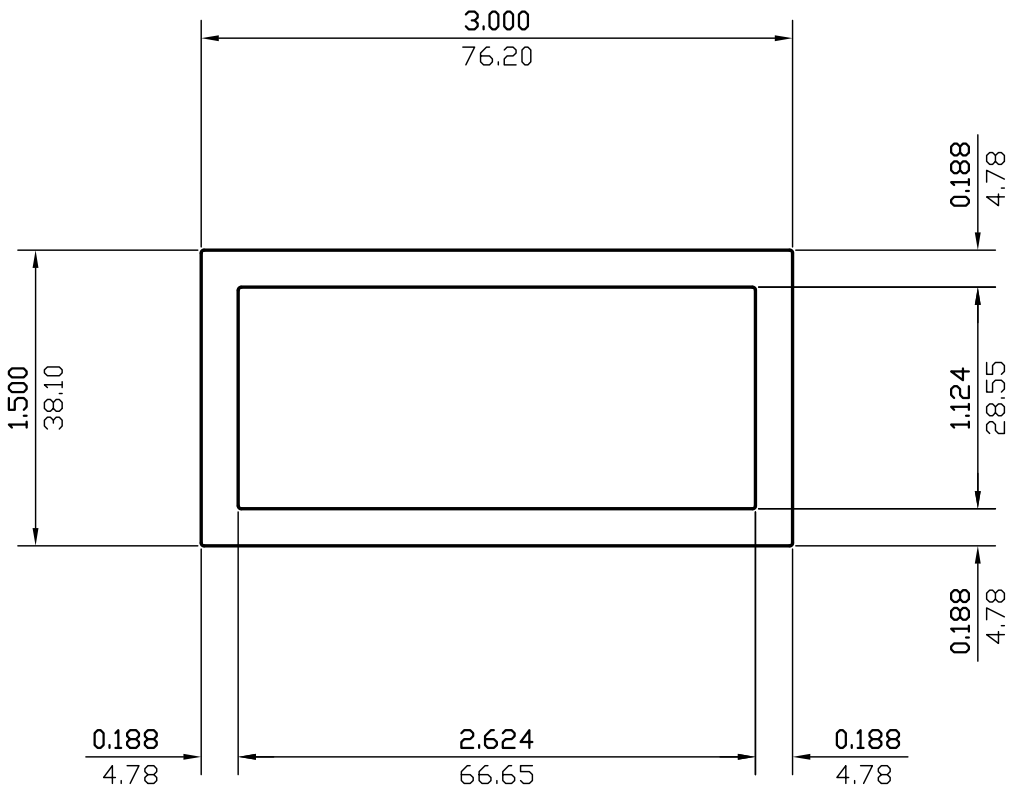

WALL THICKNESS **0.188 (4.78)** EXCEPT AS SHOWN

DATE	REV	DESCRIPTION	BY
03/14/23	1	REMOVED ALLOY	JASON
EST. AREA	1.551	IN. ²	EST. AREA
EST. WT.	1.830	LBS/FT.	EST. WT.
EST. PER.	16.444	IN.	EST. PER.
OUT PER.	8.974	IN.	OUT PER.
C.C.D.	3.341	IN.	C.C.D.
FACTOR	9	FINISH	M/F
CKD BY		SCALE	1:1
		DWN BY	P.M.
		DATE	07/02/2002

CAN ART

ALUMINUM EXTRUSION INC.

85 PARKSHORE DRIVE
BRAMPTON, ONT L6T 5M1
TEL. NO. (905) 791-1464
FAX NO. (905) 791-9151
E-MAIL: canart@canart.com

THIS DRAWING IS NOT NECESSARILY A COPY OF YOUR ORIGINAL. PLEASE APPROVE DIMENSIONS AND TOLERANCES INDICATED. CAN ART ASSUMES NO RESPONSIBILITY EITHER TECHNICAL OR LEGAL FOR HAVING THIS SHAPE MADE. THE CUSTOMER AGREES TO FULLY PROTECT CAN ART ALUMINUM FROM CLAIMS OF OTHERS RESULTING FROM THIS SHAPE.

SIGNED: _____ DATE: _____